

# RSB25

[400 WATT MAX.]

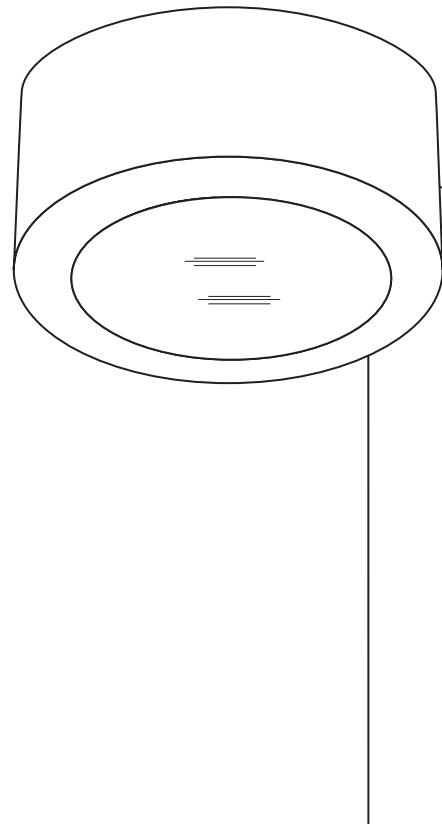

E.P.A.- 1.55

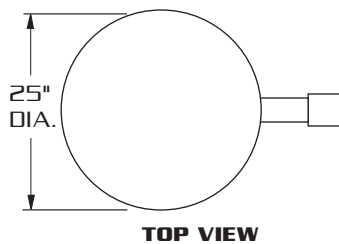
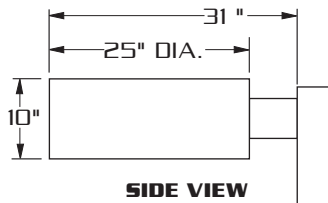

WM



1



2-180



2-90



3-90



3-120



4-90

## SPECIFICATIONS

**HOUSING:** HEAVY WALL SPUN ALUMINUM CONSTRUCTION. ENTIRE HOUSING SURFACE SHALL BE FREE OF WELDS OR SEAMS.

**LENS ASS'Y:** ONE PIECE HINGED HEAVY GAUGE DIE FORMED ALUMINUM DOOR SURROUNDS 3/16" CLEAR TEMPERED GLASS LENS. GLASS IS SEALED TO DOOR WITH HIGH TEMPERATURE SILICONE SEAL. CAPTIVE THUMB SCREW DISENGAGES LENS ASSEMBLY AND ACTIVATES ACCUHINGE™ HINGE TO ALLOW LENS ASSEMBLY TO HINGE AWAY FROM HOUSING FOR LUMINAIRE ACCESS WITHOUT THE USE OF TOOLS.

**OPTICS:** COMPUTER DESIGNED ONE PIECE SEMI SPECULAR HYDROFORMED REFLECTOR. COMBINES WITH CLEAR TEMPERED GLASS LENS TO PRODUCE A HIGHLY EFFICIENT, SHARP CUTOFF.

**GASKETING:** CLOSED CELL EPDM GASKETING COMPRESSED BETWEEN DOOR AND HOUSING WORKS IN COMBINATION WITH ACCUHINGE™ HINGE TO PRESSURE SEAL OPTICAL CHAMBER.

**LAMP HOLDER:** M06UL BASE PORCELAIN.

**LAMP:** (BY OTHERS)

**BALLAST:** H.P.F./C.W.A. AUTOTRANSFORMER. -20° STARTING TEMPERATURE.

**ARM:** 3"X5"X6" LONG HEAVY WALL EXTRUDED ALUMINUM. ARM IS SECURED TO HOUSING AND TO POLE WITH STAINLESS STEEL RODS.

**FINISH:** POLYESTER POWDER COAT-STATE OF THE ART 20 PSI PRESSURE POWER WASH AT 140° TEMPERATURE INCORPORATES FOUR STEP IRON PHOSPHATE PROCESS TO CLEANSE AND PRETREAT THE METAL SURFACE FOR MAXIMUM PAINT ADHESION. ELECTROSTATICALLY APPLIED TEXTURED POLYESTER POWDER TOP COAT IS BAKED AT 400° TEMPERATURE FOR MAXIMUM HARDNESS AND EXTERIOR DURABILITY.



660 WEST AVENUE O, PALMDALE, CA. 93551  
(661) 233-2000  
FAX NO. (661) 233-2001  
[www.usaltg.com](http://www.usaltg.com)

A7-3

**TYPICAL SQUARE POLE TEMPLATE**

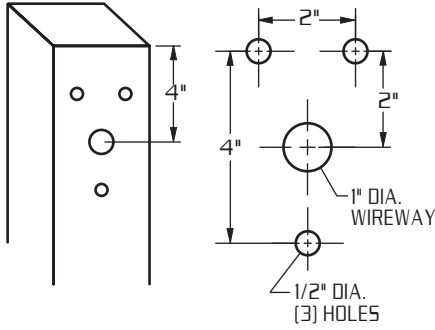

**TYPICAL ROUND POLE TEMPLATE**

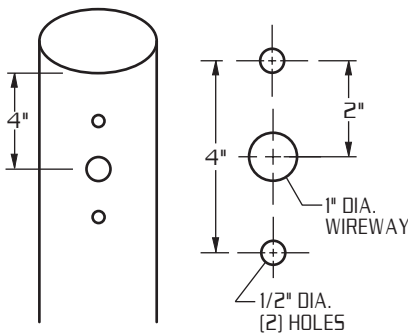

**WALL MOUNT**

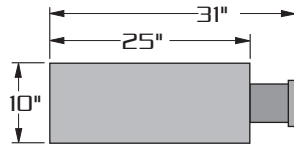
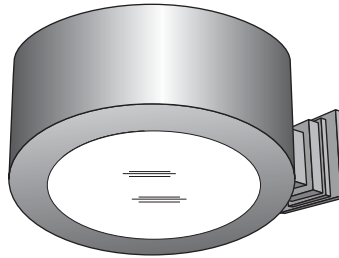

EXTRUDED ALUMINUM ARM AND CAST ALUMINUM WALL BRACKET ASSEMBLY PROVIDED WITH BUILT IN GASKETED WIRE ACCESS FOR FIXTURE/SUPPLY WIRE CONNECTION.

**WALL PLATE**

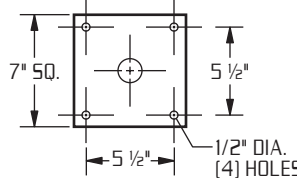

**LAMP SIZE:  
250 - 400 WATT**

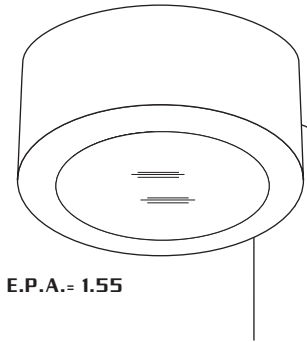

E.P.A. = 1.55

**HEAVY GAUGE SPUN ALUMINUM HOUSING.**

**FIVE LIGHT DISTRIBUTIONS AVAILABLE.**

**OPTICAL SYSTEMS ENCLOSED IN IMPACT RESISTANT TEMPERED GLASS LENS.**

**TOOLESS ENTRY TO LAMP COMPARTMENT.**

**ORDERING INFORMATION**

MODEL NO. :	OPTICS	WATTAGE TYPE VOLTAGE	MOUNTING	FINISH	OPTIONS
RSB25					

MODEL NO. :	OPTICS	LAMP	MOUNTING	FINISH	OPTIONS	
<b>R S B 2 5</b>	<input type="checkbox"/> TYPE II II..... (hydroform)	<input type="checkbox"/> 400 <input type="checkbox"/> HPS <input type="checkbox"/> 120 <input type="checkbox"/> 250 <input type="checkbox"/> MH <input type="checkbox"/> 208 <input type="checkbox"/> MV <input type="checkbox"/> 240 <input type="checkbox"/> 277 <input type="checkbox"/> 480 <input type="checkbox"/> MT	<b>ARM MOUNT</b> <input type="checkbox"/> 1 ..... ● <b>STREET LIGHTING ARM MOUNT</b> <input type="checkbox"/> ST 23 ..... ● (TO FIT OVER 2 3/8" O.D. ARM) <b>ADJUSTABLE KNUCKLE</b> <input type="checkbox"/> NKLE23 ..... ● (TO FIT OVER 2 3/8" O.D.) <input type="checkbox"/> NKLE27 ..... ● (TO FIT OVER 2 7/8" O.D.) <b>WALL MOUNT</b> <input type="checkbox"/> WM ..... ●	<input type="checkbox"/> DARK BRONZE DBM <input type="checkbox"/> MEDIUM BRONZE MBM <input type="checkbox"/> BLACK BKM <input type="checkbox"/> WHITE WTM <input type="checkbox"/> SILVER SLM <b>OPTION:</b> <input type="checkbox"/> ANODIZED AZ ANODIZED HOUSING MUST HAVE PAINT FINISH COAT EXAMPLE: AZDBM SEE PAGE 3 FOR ADDITIONAL COLORS	<input type="checkbox"/> CLEAR POLYCARBONATE DIFFUSER ..... LEX <input type="checkbox"/> HOUSE SIDE SHIELD ..... HS <input type="checkbox"/> PHOTO CELL + VOLTAGE (EXAMPLE: PC120V) ..... PC+V <input type="checkbox"/> TWIST LOCK PHOTO CELL+VOLTAGE (EXAMPLE TPC120V) ..... TPC+V <input type="checkbox"/> TWIST LOCK RECEPTACLE ONLY ..... TPR <input type="checkbox"/> SINGLE FUSE (120V., 277V) ..... SF <input type="checkbox"/> DOUBLE FUSE (208V., 240V) ..... DF	
	<input type="checkbox"/> TYPE III III..... (hydroform)					
	<input type="checkbox"/> TYPE IV (FORWARD THROW) IV..... (segmented)					
	<input type="checkbox"/> TYPE V V-SQ... (segmented)					
		<b>METAL HALIDE UNITS ONLY</b> USE ED28 LAMP FOR 400 W.	SEE ACCESSORIES SECTION FOR ST23 AND NKLE DETAILS			



660 WEST AVENUE O, PALMDALE, CA. 93551  
 (661) 233-2000  
 FAX NO. (661) 233-2001  
 www.usaltg.com