

# LUMENATOR PT2

[400 WATT MAX.]

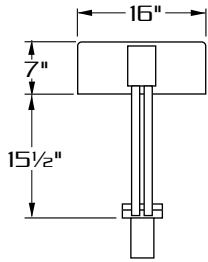

**SIDE VIEW**

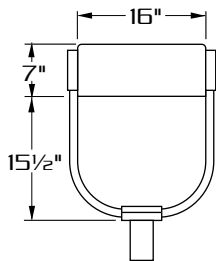

**FRONT VIEW**

E.P.A.= 1.36



## SPECIFICATIONS

**HOUSING:** PRECISE. ROUND CORNER CAST ALUMINUM CONSTRUCTION.

**LENS ASS'Y:** PRECISE. DURABLE CAST ALUMINUM DOOR FRAME SURROUNDS 3/16" CLEAR TEMPERED GLASS LENS. GLASS IS SEALED TO DOOR WITH HIGH TEMPERATURE SILICONE SEAL.

**OPTICS:** COMPUTER DESIGNED SPECULAR SEGMENTED REFLECTOR WITH AN AUXILIARY HAMMERED PATTERNED TOP REFLECTOR COMBINES WITH LENS TO PRODUCE AN EFFICIENT SHARP CUTOFF LIGHT DISTRIBUTION.

**GASKETING:** CLOSED CELL EPDM GASKETING COMPRESSED BETWEEN DOOR AND HOUSING SEALS OPTICAL CHAMBER.

**LAMP HOLDER:** MOGUL BASE PORCELAIN.

**LAMP:** (BY OTHERS)

**BALLAST:** H.P.F./C.W.A. AUTOTRANSFORMER. -20° STARTING TEMPERATURE.

**ARM:** FOUR (4) ONE INCH SQUARE EXTRUDED ALUMINUM ARMS WELDED TO A CAST ALUMINUM POLE TOP FITTER. ARM ASSEMBLY IS MECHANICALLY ATTACHED TO TWIN CASTINGS WELDED TO EITHER SIDE OF THE HOUSING.

**FINISH:** POLYESTER POWDER COAT-STATE OF THE ART 20 PSI PRESSURE POWER WASH AT 140° TEMPERATURE INCORPORATES FOUR STEP IRON PHOSPHATE PROCESS TO CLEANSE AND PRETREAT THE METAL SURFACE FOR MAXIMUM PAINT ADHESION. ELECTROSTATICALLY APPLIED TEXTURED POLYESTER POWDER TOP COAT IS BAKED AT 400° TEMPERATURE FOR MAXIMUM HARDNESS AND EXTERIOR DURABILITY.



**MOUNTING STYLES**

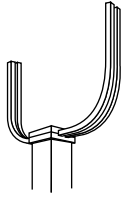

**PTA**

STANDARD TENON ASSEMBLY FOR 4" & 5" SQUARE POLES.

DECORATIVE RING SUPPLIED FOR 6" SQUARE POLES. (SPECIFY POLE I.O.)

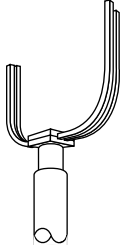

**PTB**

TENON ASSEMBLY FOR TAPERED OR ROUND POLES. TENON ASSEMBLY IS ALSO AVAILABLE AS AN OPTION FOR 4", 5" OR 6" SQUARE POLES.

SPECIFY MOUNTING ASSEMBLY:

**PTB27**-TO FIT OVER 2 7/8" O.D. TENON.

**PTB23**-TO FIT OVER 2 3/8" O.D. TENON.

**WALL MOUNT**

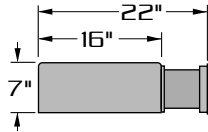
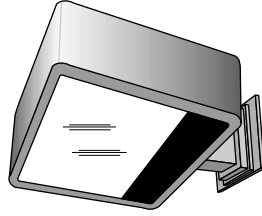

EXTRUDED ALUMINUM ARM AND CAST ALUMINUM WALL BRACKET ASSEMBLY PROVIDED WITH BUILT IN GASKETED WIRE ACCESS FOR FIXTURE/SUPPLY WIRE CONNECTION.

**WALL PLATE**

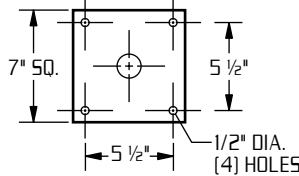

**LAMP SIZE:  
100 - 400 WATT**

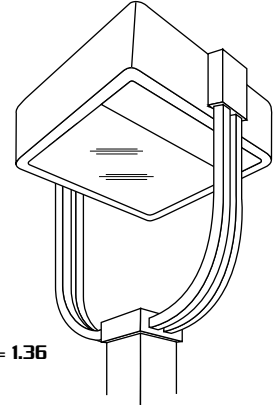

E.P.A. = 1.36

**PRECISE COMPUTER DESIGNED,  
SEGMENTED SHARP CUTOFF OPTICS.**

**IMPACT RESISTANT TEMPERED  
GLASS LENS.**

**SOFT CORNER DESIGN HOUSING.**

**ORDERING INFORMATION**

MODEL NO.:	OPTICS	WATTAGE TYPE VOLTAGE	MOUNTING	FINISH	OPTIONS
LUMPT2					
MODEL NO.:	OPTICS	LAMP	MOUNTING	FINISH	OPTIONS
LUMPT2	<input type="checkbox"/> TYPE III III.....	<input type="checkbox"/> 400 <input type="checkbox"/> HPS <input type="checkbox"/> 120 <input type="checkbox"/> 250 <input type="checkbox"/> MH <input type="checkbox"/> 208 <input type="checkbox"/> 200 <input type="checkbox"/> MV <input type="checkbox"/> 240 <input type="checkbox"/> 175 <input type="checkbox"/> 277 <input type="checkbox"/> 150 <input type="checkbox"/> 480 <input type="checkbox"/> 100 <input type="checkbox"/> MT	<input type="checkbox"/> PTA  <input type="checkbox"/> PTB23 (TO FIT 2 3/8" O.D.) <input type="checkbox"/> PTB27 (TO FIT 2 7/8" O.D.)  <input type="checkbox"/> WALL MOUNT <input type="checkbox"/> WM.....	<input type="checkbox"/> DARK BRONZE DBM <input type="checkbox"/> MEDIUM BRONZE MBM <input type="checkbox"/> BLACK BKM <input type="checkbox"/> WHITE WTM <input type="checkbox"/> SILVER SLM	<input type="checkbox"/> CLEAR POLYCARBONATE DIFFUSER.....LEX <input type="checkbox"/> HOUSE SIDE SHIELD.....HS <input type="checkbox"/> PHOTO CELL + VOLTAGE (EXAMPLE: PC120V).....PC+V <input type="checkbox"/> TWIST LOCK PHOTO CELL+VOLTAGE (EXAMPLE TPC120V).....TPC+V <input type="checkbox"/> TWIST LOCK RECEPTACLE ONLY.....TPR <input type="checkbox"/> SINGLE FUSE (120V., 277V).....SF <input type="checkbox"/> DOUBLE FUSE (208V., 240V).....DF
	<input type="checkbox"/> TYPE V V-SQ...	<b>METAL HALIDE UNITS ONLY</b> USE ED28 LAMP FOR 400 W. USE MEDIUM BASE LAMP FOR 100 W.		SEE PAGE 3 FOR ADDITIONAL COLORS	

