

LUMENATOR PT2

[400 WATT MAX.]

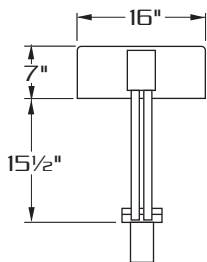

SIDE VIEW

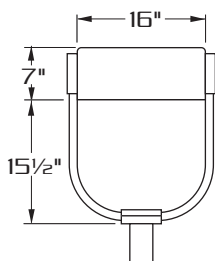

FRONT VIEW

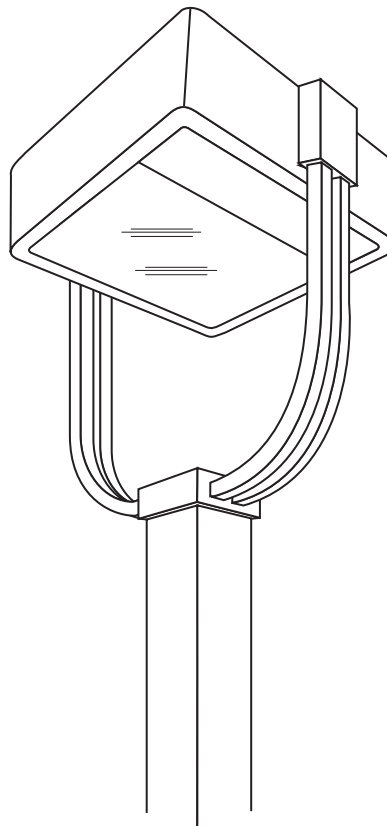

E.P.A. = 1.36



SPECIFICATIONS

HOUSING: PRECISE, ROUND CORNER CAST ALUMINUM CONSTRUCTION.

LENS ASS'Y: PRECISE, DURABLE CAST ALUMINUM DOOR FRAME SURROUNDS 3/16" CLEAR TEMPERED GLASS LENS. GLASS IS SEALED TO DOOR WITH HIGH TEMPERATURE SILICONE SEAL.

OPTICS: COMPUTER DESIGNED SPECULAR SEGMENTED REFLECTOR WITH AN AUXILIARY HAMMERED PATTERNED TOP REFLECTOR COMBINES WITH LENS TO PRODUCE AN EFFICIENT SHARP CUTOFF LIGHT DISTRIBUTION.

GASKETING: CLOSED CELL EPDM GASKETING COMPRESSED BETWEEN DOOR AND HOUSING SEALS OPTICAL CHAMBER.

LAMP HOLDER: MOGUL BASE PORCELAIN.

LAMP: (BY OTHERS)

BALLAST: H.P.F./C.W.A. AUTOTRANSFORMER, -20° STARTING TEMPERATURE.

ARM: FOUR (4) ONE INCH SQUARE EXTRUDED ALUMINUM ARMS WELDED TO A CAST ALUMINUM POLE TOP FITTER. ARM ASSEMBLY IS MECHANICALLY ATTACHED TO TWIN CASTINGS WELDED TO EITHER SIDE OF THE HOUSING.

FINISH: POLYESTER POWDER COAT-STATE OF THE ART 20 PSI PRESSURE POWER WASH AT 140° TEMPERATURE INCORPORATES FOUR STEP IRON PHOSPHATE PROCESS TO CLEANSE AND PRETREAT THE METAL SURFACE FOR MAXIMUM PAINT ADHESION. ELECTROSTATICALLY APPLIED TEXTURED POLYESTER POWDER TOP COAT IS BAKED AT 400° TEMPERATURE FOR MAXIMUM HARDNESS AND EXTERIOR DURABILITY.



660 WEST AVENUE O, PALMDALE, CA. 93551
(661) 233-2000
FAX NO. (661) 233-2001
www.usaltg.com

A4-3

MOUNTING STYLES

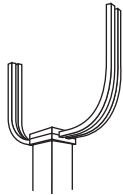

PTA

STANDARD TENON ASSEMBLY FOR 4" & 5" SQUARE POLES.

DECORATIVE RING SUPPLIED FOR 6" SQUARE POLES. (SPECIFY POLE I.D.)

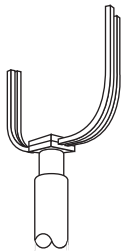

PTB

TENON ASSEMBLY FOR TAPERED OR ROUND POLES. TENON ASSEMBLY IS ALSO AVAILABLE AS AN OPTION FOR 4", 5" OR 6" SQUARE POLES.

SPECIFY MOUNTING ASSEMBLY:

PTB27-TO FIT OVER 2 7/8" O.D. TENON.

PTB23-TO FIT OVER 2 3/8" O.D. TENON.

WALL MOUNT

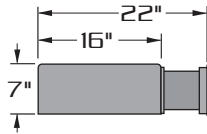
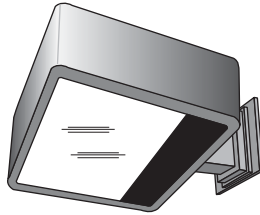

EXTRUDED ALUMINUM ARM AND CAST ALUMINUM WALL BRACKET ASSEMBLY PROVIDED WITH BUILT IN GASKETED WIRE ACCESS FOR FIXTURE/SUPPLY WIRE CONNECTION.

WALL PLATE

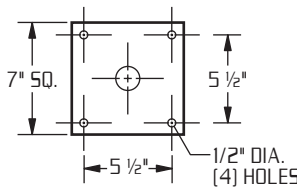

**LAMP SIZE:
100 - 400 WATT**

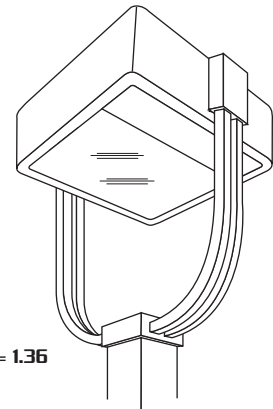

E.P.A.= 1.36

**PRECISE COMPUTER DESIGNED,
SEGMENTED SHARP CUTOFF
OPTICS.**

**IMPACT RESISTANT TEMPERED
GLASS LENS.**

SOFT CORNER DESIGN HOUSING.

ORDERING INFORMATION

MODEL NO.:	OPTICS	WATTAGE TYPE VOLTAGE	MOUNTING	FINISH	OPTIONS
LUMPT2					

MODEL NO.:	OPTICS	LAMP	MOUNTING	FINISH	OPTIONS																		
LUMPT2	<input type="checkbox"/> TYPE III 	<table border="0"> <tr> <td><input type="checkbox"/> 400</td> <td><input type="checkbox"/> HPS</td> <td><input type="checkbox"/> 120</td> </tr> <tr> <td><input type="checkbox"/> 250</td> <td><input type="checkbox"/> MH</td> <td><input type="checkbox"/> 208</td> </tr> <tr> <td><input type="checkbox"/> 200</td> <td><input type="checkbox"/> MV</td> <td><input type="checkbox"/> 240</td> </tr> <tr> <td><input type="checkbox"/> 175</td> <td></td> <td><input type="checkbox"/> 277</td> </tr> <tr> <td><input type="checkbox"/> 150</td> <td></td> <td><input type="checkbox"/> 480</td> </tr> <tr> <td><input type="checkbox"/> 100</td> <td></td> <td><input type="checkbox"/> MT</td> </tr> </table>	<input type="checkbox"/> 400	<input type="checkbox"/> HPS	<input type="checkbox"/> 120	<input type="checkbox"/> 250	<input type="checkbox"/> MH	<input type="checkbox"/> 208	<input type="checkbox"/> 200	<input type="checkbox"/> MV	<input type="checkbox"/> 240	<input type="checkbox"/> 175		<input type="checkbox"/> 277	<input type="checkbox"/> 150		<input type="checkbox"/> 480	<input type="checkbox"/> 100		<input type="checkbox"/> MT	<input type="checkbox"/> PTA 	<input type="checkbox"/> DARK BRONZE DBM <input type="checkbox"/> MEDIUM BRONZE MBM <input type="checkbox"/> BLACK BKM <input type="checkbox"/> WHITE WTM <input type="checkbox"/> SILVER SLM	<input type="checkbox"/> CLEAR POLYCARBONATE DIFFUSER LEX <input type="checkbox"/> HOUSE SIDE SHIELD HS <input type="checkbox"/> PHOTO CELL + VOLTAGE (EXAMPLE: PC120V) PC+V <input type="checkbox"/> TWIST LOCK PHOTO CELL+VOLTAGE (EXAMPLE TPC120V) TPC+V <input type="checkbox"/> TWIST LOCK RECEPTACLE ONLY TPR <input type="checkbox"/> SINGLE FUSE (120V., 277V) SF <input type="checkbox"/> DOUBLE FUSE (208V., 240V) DF
	<input type="checkbox"/> 400	<input type="checkbox"/> HPS	<input type="checkbox"/> 120																				
<input type="checkbox"/> 250	<input type="checkbox"/> MH	<input type="checkbox"/> 208																					
<input type="checkbox"/> 200	<input type="checkbox"/> MV	<input type="checkbox"/> 240																					
<input type="checkbox"/> 175		<input type="checkbox"/> 277																					
<input type="checkbox"/> 150		<input type="checkbox"/> 480																					
<input type="checkbox"/> 100		<input type="checkbox"/> MT																					
	<input type="checkbox"/> TYPE V V-SQ.	<p>METAL HALIDE UNITS ONLY USE ED28 LAMP FOR 400 W. USE MEDIUM BASE LAMP FOR 100 W.</p>	<input type="checkbox"/> PTB23 (TO FIT 2 3/8" O.D.) <input type="checkbox"/> PTB27 (TO FIT 2 7/8" O.D.) WALL MOUNT <input type="checkbox"/> WM	SEE PAGE 3 FOR ADDITIONAL COLORS																			



660 WEST AVENUE O, PALMDALE, CA. 93551
 (661) 233-2000
 FAX NO. (661) 233-2001
www.usaltg.com