

# GALAXY 4

[400 WATT MAX.]

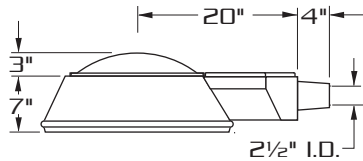

SIDE VIEW

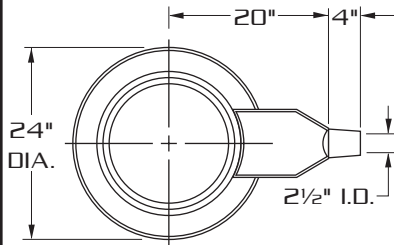

TOP VIEW

PATENT PENDING

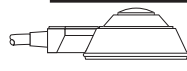

- SOLID PYRAMID TOP
- TEMPERED GLASS LENS
- HORIZONTAL LAMP
- 400 W. MAX LAMP

GLX-411

E.P.A. = 1.31



- SOLID PYRAMID TOP
- CONVEX GLASS LENS
- HORIZONTAL OR VERTICAL LAMP
- 400 W. MAX LAMP

GLX-412

E.P.A. = 1.44

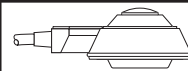

- SOLID PYRAMID TOP
- DROP GLASS LENS
- HORIZONTAL LAMP
- 400 W. MAX LAMP

GLX-413

E.P.A. = 1.44



- SOLID PYRAMID TOP
- TEAR DROP ACRYLIC
- HORIZONTAL OR VERTICAL LAMP
- 250 W. MAX LAMP

GLX-414

E.P.A. = 1.81

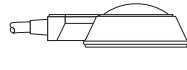

- SOLID DOME TOP
- TEMPERED GLASS LENS
- HORIZONTAL LAMP
- 400 W. MAX LAMP

GLX-421

E.P.A. = 1.22

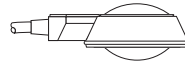

- SOLID DOME TOP
- CONVEX GLASS LENS
- HORIZONTAL OR VERTICAL LAMP
- 400 W. MAX LAMP

GLX-422

E.P.A. = 1.35

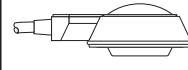

- SOLID DOME TOP
- DROP GLASS LENS
- HORIZONTAL LAMP
- 400 W. MAX LAMP

GLX-423

E.P.A. = 1.35

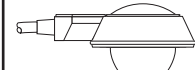

- SOLID DOME TOP
- TEAR DROP ACRYLIC
- HORIZONTAL OR VERTICAL LAMP
- 250 W. MAX LAMP

GLX-424

E.P.A. = 1.72

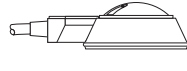

- UP-LIGHT
- TEMPERED GLASS LENS
- HORIZONTAL LAMP
- 400 W. MAX LAMP

GLX-431

E.P.A. = 1.25

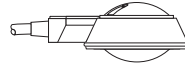

- UP-LIGHT
- CONVEX GLASS LENS
- HORIZONTAL LAMP
- 400 W. MAX LAMP

GLX-432

E.P.A. = 1.38

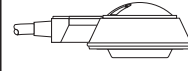

- UP-LIGHT
- DROP GLASS LENS
- HORIZONTAL LAMP
- 400 W. MAX LAMP

GLX-433

E.P.A. = 1.38

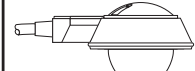

- UP-LIGHT
- TEAR DROP ACRYLIC
- HORIZONTAL LAMP
- 250 W. MAX LAMP

GLX-434

E.P.A. = 1.75

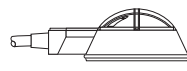

- UP-LIGHT WITH CAST GUARD
- TEMPERED GLASS LENS
- HORIZONTAL LAMP
- 400 W. MAX LAMP

GLX-441

E.P.A. = 1.28

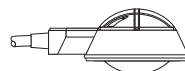

- UP-LIGHT WITH CAST GUARD
- CONVEX GLASS LENS
- HORIZONTAL LAMP
- 400 W. MAX LAMP

GLX-442

E.P.A. = 1.41

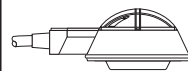

- UP-LIGHT WITH CAST GUARD
- DROP GLASS LENS
- HORIZONTAL LAMP
- 400 W. MAX LAMP

GLX-443

E.P.A. = 1.41

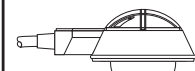

- UP-LIGHT WITH CAST GUARD
- TEAR DROP ACRYLIC
- HORIZONTAL LAMP
- 250 W. MAX LAMP

GLX-444

E.P.A. = 1.78



WM



1



2-180



2-90



3-90



3-120



4-90

## SPECIFICATIONS

**HOUSING:** DURABLE CORROSION RESISTANT. PRECISE CAST ALUMINUM CONSTRUCTION.

**LENS ASS'Y:** ONE PIECE, DIE FORMED ALUMINUM DOOR FRAME SURROUNDS LENS. LENS IS SEALED TO DOOR FRAME WITH HIGH TEMPERATURE SILICONE SEAL. CAPTIVE THUMB SCREW IS LOOSENEED TO DISENGAGE LENS ASSEMBLY FROM HOUSING. THIS ACTIVATES ACCUHINGE™ TO ALLOW LENS ASSEMBLY TO HINGE AWAY FROM HOUSING FOR LUMINAIRE ACCESS WITHOUT USE OF TOOLS.

**OPTICS:** COMPUTER DESIGNED SPECULAR SEGMENTED SIDE REFLECTORS WITH AN AUXILIARY PATTERNED TOP REFLECTOR COMBINES WITH CLEAR TEMPERED GLASS LENS TO PRODUCE AN EXTREMELY EFFICIENT ASYMMETRIC LIGHT DISTRIBUTION WITH SHARP CUTOFF. (OTHER OPTICS AVAILABLE. SEE ORDERING INFORMATION)

**GASKETING:** CLOSED CELL EPDM GASKETING COMPRESSED BETWEEN DOOR FRAME AND HOUSING WORKS IN COMBINATION WITH ACCUHINGE™ TO PRESSURE SEAL OPTICAL CHAMBER AND PREVENT ENTRY OF CONTAMINANTS INTO OPTICAL CHAMBER.

**LAMP HOLDER:** MOGUL BASE PORCELAIN.

**LAMP:** (BY OTHERS)

**BALLAST:** H.P.F./C.W.A. AUTOTRANSFORMER. -20° STARTING TEMPERATURE.

**ARM:** CORROSION RESISTANT TWO PIECE CAST ALUMINUM CONSTRUCTION. REMOVABLE ARM COVER GASKETED TO PRESSURE SEAL ARM WHICH HOUSES BALLAST.

**FINISH:** POLYESTER POWDER COAT-STATE OF THE ART 20 PSI PRESSURE POWER WASH AT 140° TEMPERATURE INCORPORATES FOUR STEP IRON PHOSPHATE PROCESS TO CLEANSE AND PRETREAT THE METAL SURFACE FOR MAXIMUM PAINT ADHESION. ELECTROSTATICALLY APPLIED TEXTURED POLYESTER POWDER TOPCOAT IS BAKED AT 400° TEMPERATURE FOR MAXIMUM HARDNESS AND EXTERIOR DURABILITY.



660 WEST AVENUE O, PALMDALE, CA. 93551

(661) 233-2000

FAX NO. (661) 233-2001

www.usaltg.com

A6-7

## WALL MOUNT

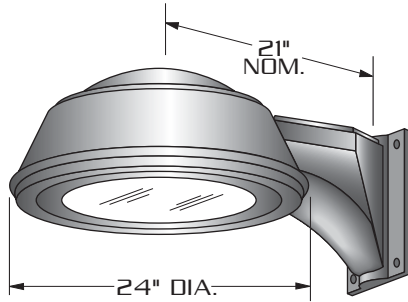

CORROSION RESISTANT CAST ALUMINUM ARM IS SUPPLIED WITH REMOVABLE CAST ALUMINUM TOP CAP FOR EASY ACCESS TO ELECTRICAL COMPONENTS.

## WALL PLATE

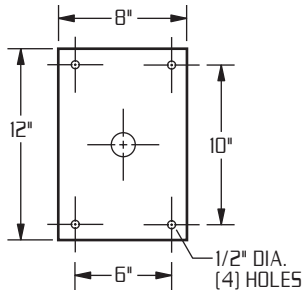

LAMP SIZE:  
70 - 400 WATT

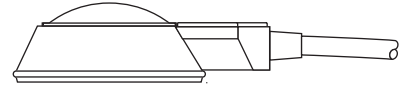

PATENT PENDING

DURABLE CAST ALUMINUM CONSTRUCTION.

HORIZONTAL AND VERTICAL LAMP OPTIONS.

FIVE LIGHT DISTRIBUTIONS.

DECORATIVE UPLIGHT COMPONENT. (430 AND 440 SERIES)

## ORDERING INFORMATION

MODEL NO. : GLX-	OPTICS	WATTAGE TYPE VOLTAGE	MOUNTING	FINISH	OPTIONS
<b>MODEL NO. :</b> <b>GLX-</b>	<b>OPTICS</b>	<b>LAMP</b>	<b>MOUNTING</b>	<b>FINISH</b>	<b>OPTIONS</b>
<b>G L X</b>	<b>HORIZONTAL LAMP REFLECTORS</b>	<b>WATTAGE TYPE VOLTAGE</b>	<input type="checkbox"/> <b>ST23</b> .....● (TO FIT OVER 2 3/8" O.D. ARM)	<input type="checkbox"/> <b>DARK BRONZE DBM</b>	<input type="checkbox"/> <b>HOUSE SIDE SHIELD</b> ..... <b>HS</b>
	<input type="checkbox"/> <b>TYPE II HR-II</b> ..... (hydroform, horizontal lamp)	<input type="checkbox"/> <b>400</b> <input type="checkbox"/> <b>HPS</b> <input type="checkbox"/> <b>120</b>	<input type="checkbox"/> <b>WM</b> .....●	<input type="checkbox"/> <b>MEDIUM BRONZE MBM</b>	<input type="checkbox"/> <b>PHOTO CELL + VOLTAGE</b> (EXAMPLE: PC120V) ..... <b>PC+V</b>
<input type="checkbox"/> <b>TYPE III HR-III</b> ..... (segmented, horizontal lamp)	<input type="checkbox"/> <b>250</b> <input type="checkbox"/> <b>MH</b> <input type="checkbox"/> <b>208</b>	<input type="checkbox"/> <b>200</b> <input type="checkbox"/> <b>MV</b> <input type="checkbox"/> <b>240</b>		<input type="checkbox"/> <b>BLACK BKM</b>	<input type="checkbox"/> <b>SINGLE FUSE</b> (120V. , 277V) ..... <b>SF</b>
<input type="checkbox"/> <b>TYPE IV (FORWARD THROW) HR-IV</b> ..... (segmented, horizontal lamp)	<input type="checkbox"/> <b>175</b> <input type="checkbox"/> <b>277</b>	<input type="checkbox"/> <b>150</b> <input type="checkbox"/> <b>480</b>		<input type="checkbox"/> <b>WHITE WTM</b>	<input type="checkbox"/> <b>DOUBLE FUSE</b> (208V. , 240V) ..... <b>DF</b>
<input type="checkbox"/> <b>TYPE V HR-V-SQ</b> ..... (segmented, horizontal lamp)	<input type="checkbox"/> <b>100</b> <input type="checkbox"/> <b>MT</b>	<input type="checkbox"/> <b>75</b>		<input type="checkbox"/> <b>SILVER SLM</b>	
<b>VERTICAL LAMP REFLECTORS</b>	<input type="checkbox"/> <b>70</b>				
<input type="checkbox"/> <b>ASYMMETRIC ASY</b> ..... (segmented, vertical lamp)					
<input type="checkbox"/> <b>TYPE V VR-V-SQ</b> ..... (segmented, vertical lamp)					
		<b>METAL HALIDE UNITS ONLY</b> USE ED28 LAMP FOR 400 W. USE MEDIUM BASE LAMP FOR 100 W.		<b>SEE PAGE 3 FOR ADDITIONAL COLORS</b>	