

APOGEE-W14

[175 WATT MAX.]

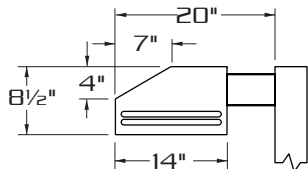

SIDE VIEW

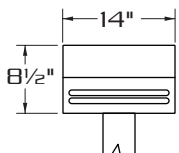

FRONT VIEW

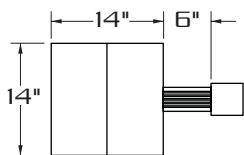

TOP VIEW



E.P.A.= 1.07



WM



1



2-180



2-90



3-90



3-120



4-90

SPECIFICATIONS

HOUSING: ONE PIECE HEAVY GAUGE DIE FORMED ALUMINUM CONSTRUCTION. HOUSING FURNISHED WITH DECORATIVE REVEALS TO PROVIDE CONTEMPORARY AESTHETICS. HOUSING REVEALS CAN BE SUPPLIED WITH ACCENT COLORS TO SIGNATURIZE INSTALLATION.

LENS ASSY: ONE PIECE HINGED HEAVY GAUGE DIE FORMED ALUMINUM DOOR FRAME SURROUNDS 3/16" CLEAR TEMPERED GLASS LENS. GLASS IS SEALED TO DOOR WITH HIGH TEMPERATURE SILICONE SEAL. TWO CAPTIVE THUMB SCREWS DISENGAGE LENS ASSEMBLY FROM HOUSING WITHOUT THE USE OF TOOLS.

OPTICS: COMPUTER DESIGNED ONE PIECE SPECULAR SEGMENTED REFLECTOR COMBINES WITH LENS TO PRODUCE A HIGHLY EFFICIENT, SHARP CUTOFF OR WIDE ANGLE LIGHT DISTRIBUTION. OPTICAL ASSEMBLY IS REMOVABLE WITHOUT USE OF TOOLS FOR ACCESS TO BALLAST TRAY. OPTICS ARE FIELD ROTATABLE IN 90° INCREMENTS.

GASKETING: CLOSED CELL EPDM GASKETING COMPRESSED BETWEEN DOOR AND HOUSING SEALS OPTICAL CHAMBER.

LAMP HOLDER: M06UL BASE PORCELAIN. LAMP HOLDER EQUIPPED WITH FACTORY INSTALLED QUICK DISCONNECT PLUG.

LAMP: (BY OTHERS)

BALLAST: ELECTRICAL COMPONENTS ARE FACTORY PREWIRED WITH QUICK-DISCONNECT PLUGS AND ARE MOUNTED TO A REMOVABLE BALLAST TRAY. ENTIRE BALLAST ASSEMBLY IS REMOVABLE FROM HOUSING WITHOUT USE OF TOOLS.

ARM: 3"X5"X9" HEAVY WALL EXTRUDED ALUMINUM. ARM IS DESIGNED WITH HORIZONTAL RIBS TO COMPLIMENT STYLING ON HOUSING.

HARDWARE: ALL EXPOSED HARDWARE IS STAINLESS STEEL.

FINISH: POLYESTER POWDER COAT-STATE OF THE ART 20 PSI PRESSURE POWER WASH AT 140° TEMPERATURE INCORPORATES FOUR STEP IRON PHOSPHATE PROCESS TO CLEANSE AND PRETREAT THE METAL SURFACE FOR MAXIMUM PAINT ADHESION. ELECTROSTATICALLY APPLIED TEXTURED POLYESTER POWDER TOP COAT IS BAKED AT 400° TEMPERATURE FOR MAXIMUM HARDNESS AND EXTERIOR DURABILITY.



660 WEST AVENUE O, PALMDALE, CA. 93551
 (661) 233-2000
 FAX NO. (661) 233-2001
www.usaltg.com

A12-9

TYPICAL SQUARE POLE TEMPLATE

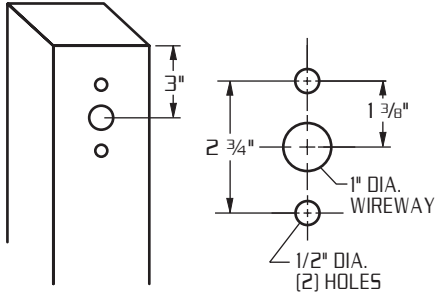

TYPICAL ROUND POLE TEMPLATE

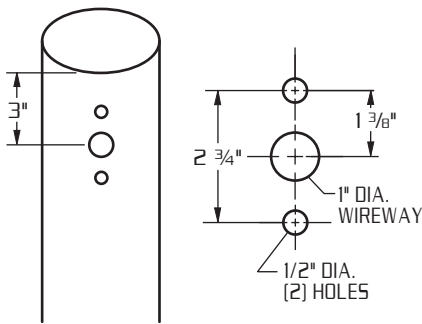

WALL MOUNT

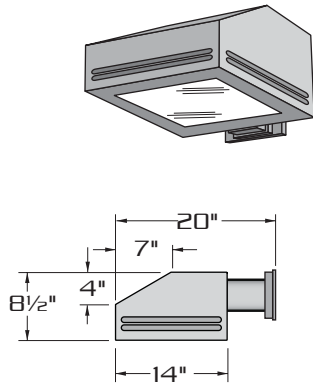

FACTORY INSTALLED EXTRUDED ALUMINUM ARM SECURED TO CAST ALUMINUM WALL BRACKET. ARM IS PROVIDED WITH BUILT IN GASKETED WIRE ACCESS FOR FIXTURE/SUPPLY WIRE CONNECTION.

WALL PLATE

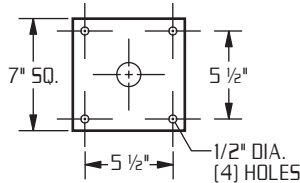

**LAMP SIZE:
50 - 175 WATT**

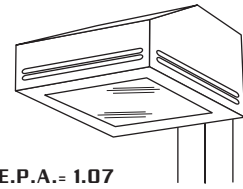

RECTILINEAR HEAVY GAUGE ALUMINUM HOUSING.

FIELD ROTATABLE OPTICS.

SHARP CUTOFF HORIZONTAL AND WIDE ANGLE VERTICAL LAMP OPTICS.

TOOLESS LAMP AND BALLAST ACCESS.

TOOLESS REMOVABLE BALLAST TRAY PROVIDED WITH QUICK DISCONNECT PLUG FOR EASY SERVICING.

ORDERING INFORMATION

MODEL NO. : APG-W14	OPTICS	WATTAGE	TYPE	VOLTAGE	MOUNTING	FINISH	OPTIONS
APG-W14	HORIZONTAL LAMP				ARM MOUNT	<input type="checkbox"/> DARK BRONZE DBM	<input type="checkbox"/> CLEAR TEMPERED CONVEX GLASS LENS CCG
	<input type="checkbox"/> TYPE II HR-II	<input type="checkbox"/> 175*	<input type="checkbox"/> HPS	<input type="checkbox"/> 120	<input type="checkbox"/> 1	<input type="checkbox"/> MEDIUM BRONZE MBM	<input type="checkbox"/> CLEAR POLYCARBONATE DIFFUSER LEX
	<input type="checkbox"/> TYPE III HR-III	<input type="checkbox"/> 150	<input type="checkbox"/> MH	<input type="checkbox"/> 208	<input type="checkbox"/> ST 23	<input type="checkbox"/> BLACK BKM	<input type="checkbox"/> HOUSE SIDE SHIELD HS
	<input type="checkbox"/> TYPE IV (FORWARD THROW) HR-IV	<input type="checkbox"/> 100	<input type="checkbox"/> MHPS	<input type="checkbox"/> 240	<input type="checkbox"/> ST 23	<input type="checkbox"/> WHITE WTM	<input type="checkbox"/> PHOTO CELL + VOLTAGE (EXAMPLE: PC120V) PC+V
	<input type="checkbox"/> TYPE IV (FORWARD THROW) HR-IV	<input type="checkbox"/> 70	<input type="checkbox"/> MV	<input type="checkbox"/> 277	(TO FIT OVER 2 3/8" O.D. ARM)	<input type="checkbox"/> SILVER SLM	<input type="checkbox"/> PHOTO CELL + VOLTAGE (EXAMPLE: PC120V) PC+V
	<input type="checkbox"/> TYPE V HR-V-SQ	<input type="checkbox"/> 50		<input type="checkbox"/> 480	ADJUSTABLE KNUCKLE		<input type="checkbox"/> TWIST LOCK PHOTO CELL+VOLTAGE (EXAMPLE TPC120V) TPC+V
	<input type="checkbox"/> TYPE V HR-V-SQ			<input type="checkbox"/> MT	<input type="checkbox"/> NKLE23		<input type="checkbox"/> TWIST LOCK RECEPTACLE ONLY TPR
					(TO FIT OVER 2 3/8" O.D.)		<input type="checkbox"/> SINGLE FUSE (120V. , 277V) SF
					<input type="checkbox"/> NKLE27		<input type="checkbox"/> DOUBLE FUSE (208V. , 240V) DF
					(TO FIT OVER 2 7/8" O.D.)		
	VERTICAL LAMP	MEDIUM BASE LAMP ONLY		WALL MOUNT			
<input type="checkbox"/> TYPE III VR-III				<input type="checkbox"/> WM			
<input type="checkbox"/> TYPE V VR-V-SQ							
		*175 W. MHPS AVAILABLE FOR VERTICAL LAMP ONLY					
					SEE PAGE 3 FOR ADDITIONAL COLORS		



660 WEST AVENUE O, PALMDALE, CA. 93551
(661) 233-2000
FAX NO. (661) 233-2001
www.usaltg.com