

SOLID STATE AREA LIGHTING

RCGD SERIES-LED

SPECIFICATIONS

LUMINAIRE

One piece high impact polycarbonate globe provided with durable corrosion resistant cast aluminum fitter and cage. Standard fitter has 3" I.D. opening for tenon. All hardware is Stainless Steel.

LED POWER ARRAY™

Three-dimensional array of individual LED Tubes fastened to a retaining plate. Each LED Tube consists of circuit board populated with a multiple of LED's and is mechanically fastened to a radial aluminum heat sink. An acrylic Lens and end cap protects the LED Tube's internal components.

VERTICAL POWER ARRAY™ WITH GLASS REFRACTOR:

LED Tubes are aligned vertically and arranged radially to produce an even raw light distribution that simulates standard light sources. Array is secured within a 6" Prismatic Glass Refractor which provides the optical control. Used in conjunction with a clear smooth globe.

VERTICAL POWER ARRAY™: LED Tubes are aligned vertically and arranged radially to produce an even raw light distribution that simulates standard light sources. Produces a minimal glare, symmetric diffuse light distribution. Used in conjunction with an opal smooth diffusing globe.

LED EMITTERS

High Output LED's are driven at 350mA for nominal 1 Watt output each. LED's are available in standard Neutral White (4000K), or optional Cool White (5000K) or Warm White (3000K). Consult Factory for other LED options.

LED DRIVER

UL and CUL recognized High Power Factor, Constant Current LED drivers operate on input voltages from 120-277VAC, 50/60hz. Consult Factory for 347-480VAC. Driver is mechanically fastened to a retaining bracket. Main power quick disconnect provided. Driver has a minimum 4KV of internal surge protection, 10KV & 20KV Surge Protector optional. Dimming and High-Low Driver options available.

FINISH

Polyester powder coat incorporates four step iron phosphate process to pretreat metal surface for maximum adhesion. Top coat is baked at 400°F for maximum hardness and exterior durability.

PROJECT NAME: _____

PROJECT TYPE: _____



RCGD

PATENT PENDING

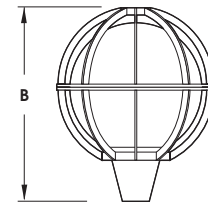
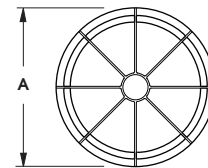

FIXTURE	A	B
RCGD22	26.5" 673mm	32" 813mm
RCGD18	21.5" 546mm	26" 660mm
RCGD14	17" 435mm	21" 533mm



2014238

RCGD SERIES - LED

S P E C I F I C A T I O N S

WALL MOUNT

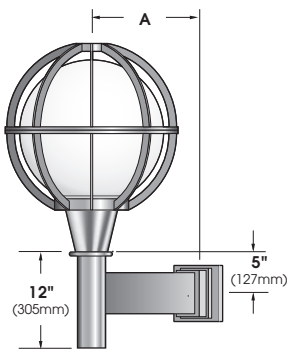

A		
RCGD22	RCGD18	RCGD14
15" 381mm	13" 330mm	11" 279mm

ARM BRACKET EXTRUDED AND CAST ALUMINUM CONSTRUCTION.

WALL PLATE

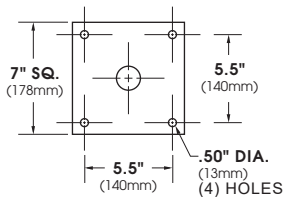

LED POWER ARRAY™ MODULES

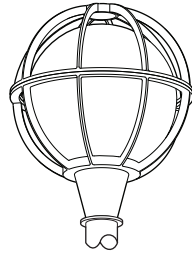

RCGD22-LED
E.P.A.= 2.61

**GLASS REFRACTOR w/
VERTICAL ARRAY**
Available in:
6 Array 36 LED Max.

VERTICAL ARRAY
Available in:
8 Array 64 LED Max.

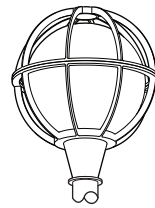

RCGD18-LED
E.P.A.= 1.73

**GLASS REFRACTOR w/
VERTICAL ARRAY**
Available in:
6 Array 36 LED Max.

VERTICAL ARRAY
Available in:
6 Array 48 LED Max.



RCGD14-LED
E.P.A.= 1.10

**GLASS REFRACTOR w/
VERTICAL ARRAY**
Available in:
6 Array 36 LED Max..

VERTICAL ARRAY
Available in:
6 Array 36 LED Max.

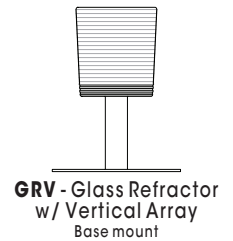

**GRV - Glass Refractor
w/ Vertical Array**
Base mount

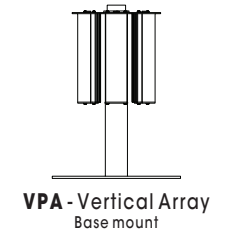

VPA - Vertical Array
Base mount

Spec/Order Example: RCGD22-LED/GRV-III/32NW480/1/RAL9005-T/PC+V

S P E C / O R D E R I N G I N F O R M A T I O N

LUMINAIRE-FITTER	OPTICS	# of LED's	COLOR	VOLTAGE	MOUNTING	FINISH	OPTIONS
LUMINAIRE	OPTICS	LED			MOUNTING	FINISH	OPTIONS
LUMINAIRE-FITTER	GLASS REFRACTOR (CLEAR ACRYLIC STANDARD)	# of LEDs	COLOR		ARM MOUNT	STANDARD TEXTURED FINISH	LENS OPTIONS:
<input type="checkbox"/> RCGD22-LED	<input type="checkbox"/> GRV - III	<input type="checkbox"/> RCGD22 36LED (40 Watts)	<input type="checkbox"/> NW (4000K)* *STANDARD		<input type="checkbox"/> 1	<input type="checkbox"/> BLACK RAL-9005-T	<input type="checkbox"/> CLEAR SMOOTH ACRYLIC CA
<input type="checkbox"/> RCGD18-LED	<input type="checkbox"/> GRV - V	<input type="checkbox"/> 36LED (40 Watts)	<input type="checkbox"/> CW (5000K)		<input type="checkbox"/> 2-180	<input type="checkbox"/> WHITE RAL-9003-T	<input type="checkbox"/> OPAL SMOOTH ACRYLIC WA
<input type="checkbox"/> RCGD14-LED		<input type="checkbox"/> RCGD14 36LED (40 Watts)	<input type="checkbox"/> WW (3000K)		<input type="checkbox"/> 2-90	<input type="checkbox"/> GREY RAL-7004-T	<input type="checkbox"/> CLEAR SMOOTH POLYCARBONATE . . . CP
		Wattages are Max Input Watts			<input type="checkbox"/> 3-90	<input type="checkbox"/> DARK BRONZE RAL-8019-T	<input type="checkbox"/> OPAL SMOOTH POLYCARBONATE . . . WP
	VERTICAL POWER ARRAY (OPAL ACRYLIC STANDARD)	<input type="checkbox"/> RCGD22 64LED (72 Watts)	VOLTAGE		<input type="checkbox"/> 3-120	<input type="checkbox"/> GREEN RAL-6005-T	<input type="checkbox"/> HOUSE SIDE SHIELD . . . HS
	<input type="checkbox"/> VPA - SYM	<input type="checkbox"/> 48LED (53 Watts)	<input type="checkbox"/> 120		<input type="checkbox"/> 4-90		<input type="checkbox"/> DIMMABLE DRIVER(S) (0-10V) DIM
		<input type="checkbox"/> 36LED (40 Watts)	<input type="checkbox"/> 208				<input type="checkbox"/> HIGH-LOW DIMMING FOR HARDWIRED SWITCHING OR NON-INTEGRATED MOTION SENSOR HLSW
		<input type="checkbox"/> 36LED (40 Watts)	<input type="checkbox"/> 240		WALL MOUNT		<input type="checkbox"/> PHOTO CELL + VOLTAGE (EXAMPLE: PC120V) PC+V
		<input type="checkbox"/> 24LED (40 Watts)	<input type="checkbox"/> 277		<input type="checkbox"/> WM		<input type="checkbox"/> 10KV SURGE PROTECTOR 10SP
			<input type="checkbox"/> 347		POST TOP		<input type="checkbox"/> 20KV SURGE PROTECTOR (277V & 480V Only) 20SP
			<input type="checkbox"/> 480		<input type="checkbox"/> PT		
						FOR SMOOTH FINISH REPLACE SUFFIX "T" WITH SUFFIX "S" (EXAMPLE: RAL-9500-S)	
						SEE USALTG.COM FOR ADDITIONAL COLORS	